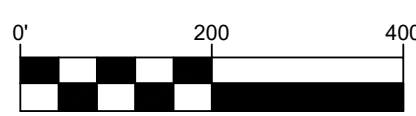
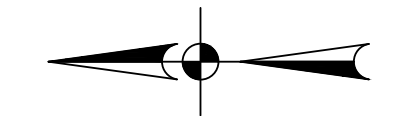
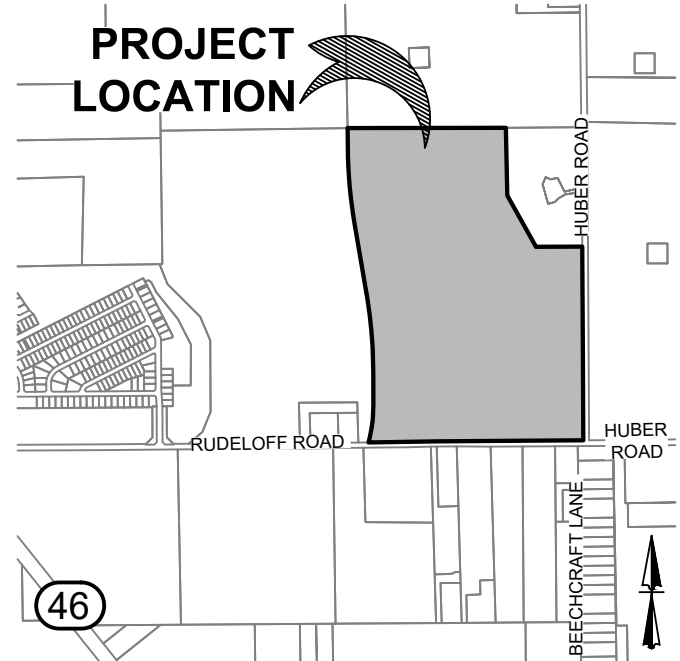
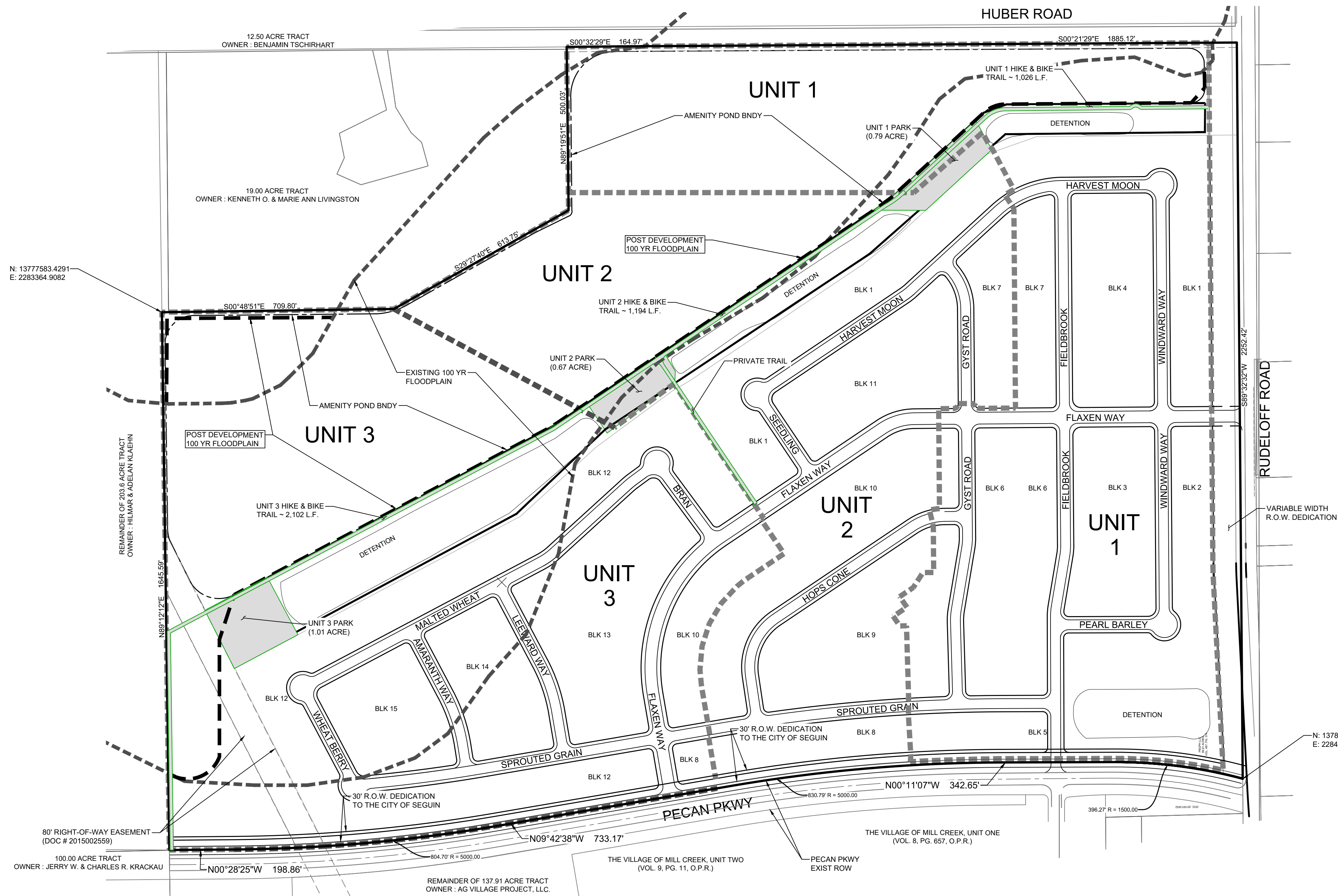

Exhibit B



LEGEND

- = BOUNDARY
- - - = PHASING LIMITS
- - - 715' - - - = EXISTING CONTOURS
- = PARK SPACE /BIKE TRAIL

GENERAL NOTES

- BEARINGS ARE BASED ON THE STATE PLANE COORDINATE SYSTEM ESTABLISHED FOR THE TEXAS SOUTH CENTRAL ZONE, NORTH AMERICAN DATUM (NAD) OF 1983.
- THE COORDINATES SHOWN HEREON ARE GRID WITH A COMBINED SCALE FACTOR OF 0.9998525.

ENGINEER / DESIGNER:
KFW ENGINEERS
162 W MILL ST
NEW BRAUNFELS, TX 78130
PHONE: (830) 220-6042
FAX: (830) 627-9097

OWNER:
PBGPH LLC
P.O. BOX 171374
SAN ANTONIO, TX 78217
PH. (210) 863-2666

THE MEADOWS OF MILL CREEK PARKS CONCEPT PLAN SEGUN, TEXAS PARK AREA EXHIBIT

JOB NO: 805-01-01
DATE: JUNE 2022
DRAWN: RM CHECKED: WF
SHEET NUMBER:

EX-B

PREPARED: July 2022

Date: Jul 25, 2022, 10:56am User ID: nasego
File: U:\Projects\805\01\01\Design\Exhibits\CAD\Park Plan Unit 1.dwg

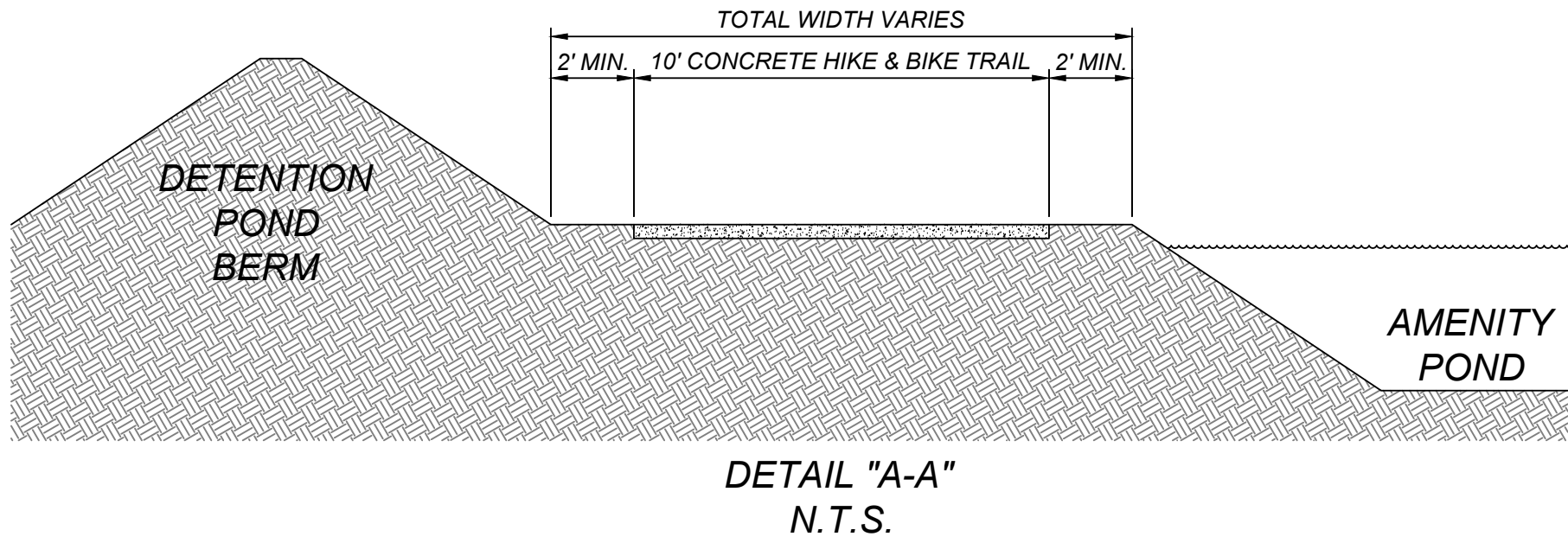
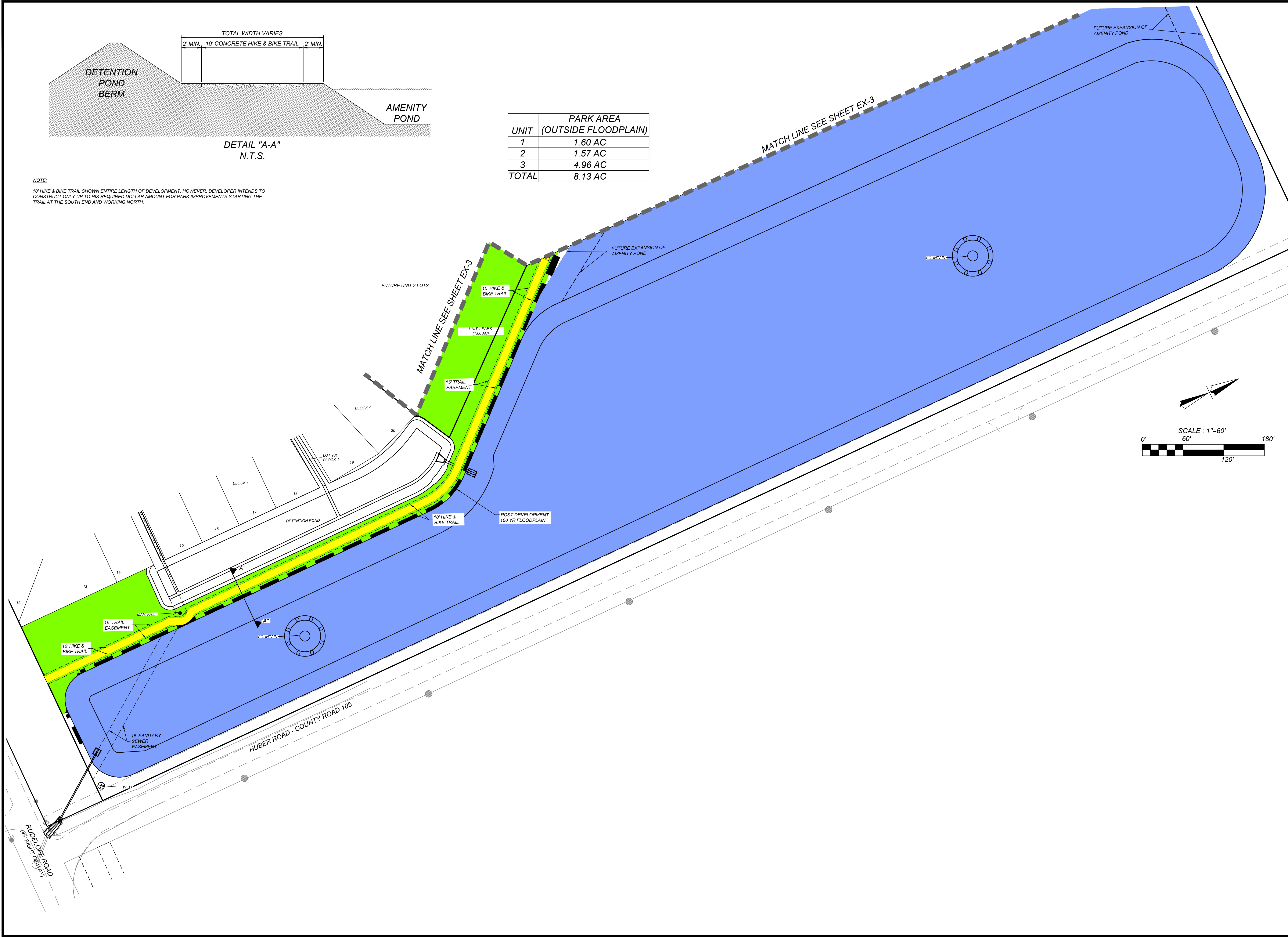

NOTE:
10' HIKE & BIKE TRAIL SHOWN ENTIRE LENGTH OF DEVELOPMENT. HOWEVER, DEVELOPER INTENDS TO CONSTRUCT ONLY UP TO HIS REQUIRED DOLLAR AMOUNT FOR PARK IMPROVEMENTS STARTING THE TRAIL AT THE SOUTH END AND WORKING NORTH.

UNIT	PARK AREA (OUTSIDE FLOODPLAIN)
1	1.60 AC
2	1.57 AC
3	4.96 AC
TOTAL	8.13 AC

MEADOWS OF MILL CREEK UNIT 1
SEGUN, TEXAS
PARK PLAN

JOB NO. 805-01-01
DATE: July 2022
DRAWN: RMRD CHECKED: WF
SHEET NUMBER:
EX-2

KFW
ENGINEERS + SURVEYING
P.O. Box 11800, Dallas, Texas 75211
Phone: (972) 221-4442 Fax: (972) 221-4447
TBPB Firm #: 9513 • TBPB Firm #: 1022300

ISSUE DATE
REVISIONS

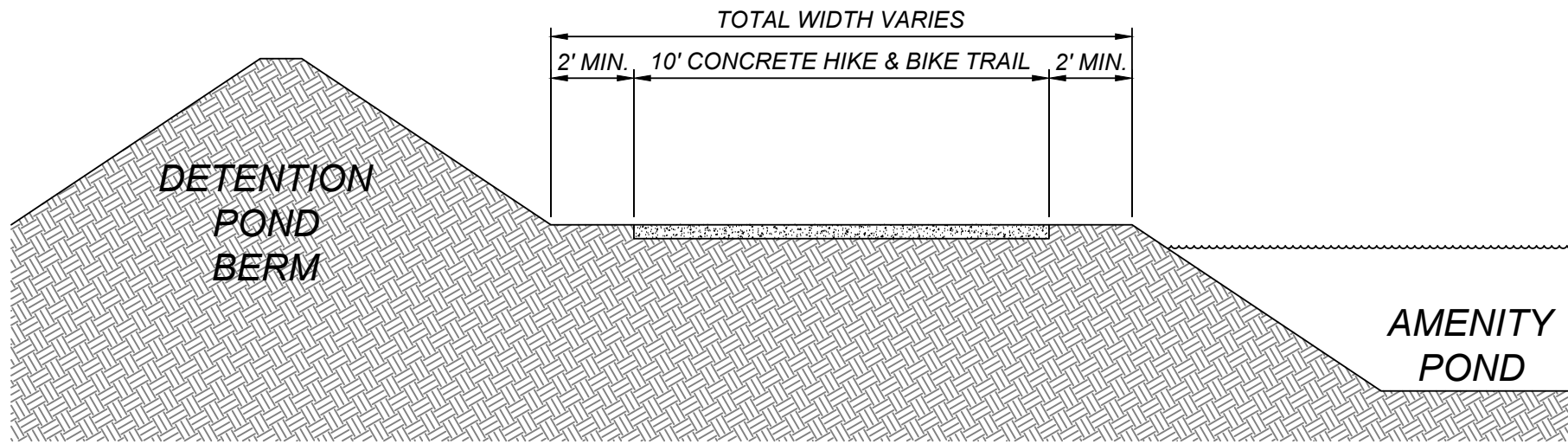

DETAIL "A-A"
N.T.S.

NOTE:
10' HIKE & BIKE TRAIL SHOWN ENTIRE LENGTH OF DEVELOPMENT. HOWEVER, DEVELOPER INTENDS TO CONSTRUCT ONLY UP TO HIS REQUIRED DOLLAR AMOUNT FOR PARK IMPROVEMENTS STARTING THE TRAIL AT THE SOUTH END AND WORKING NORTH.

UNIT	PARK AREA (OUTSIDE FLOODPLAIN)
1	1.60 AC
2	1.57 AC
3	4.96 AC
TOTAL	8.13 AC

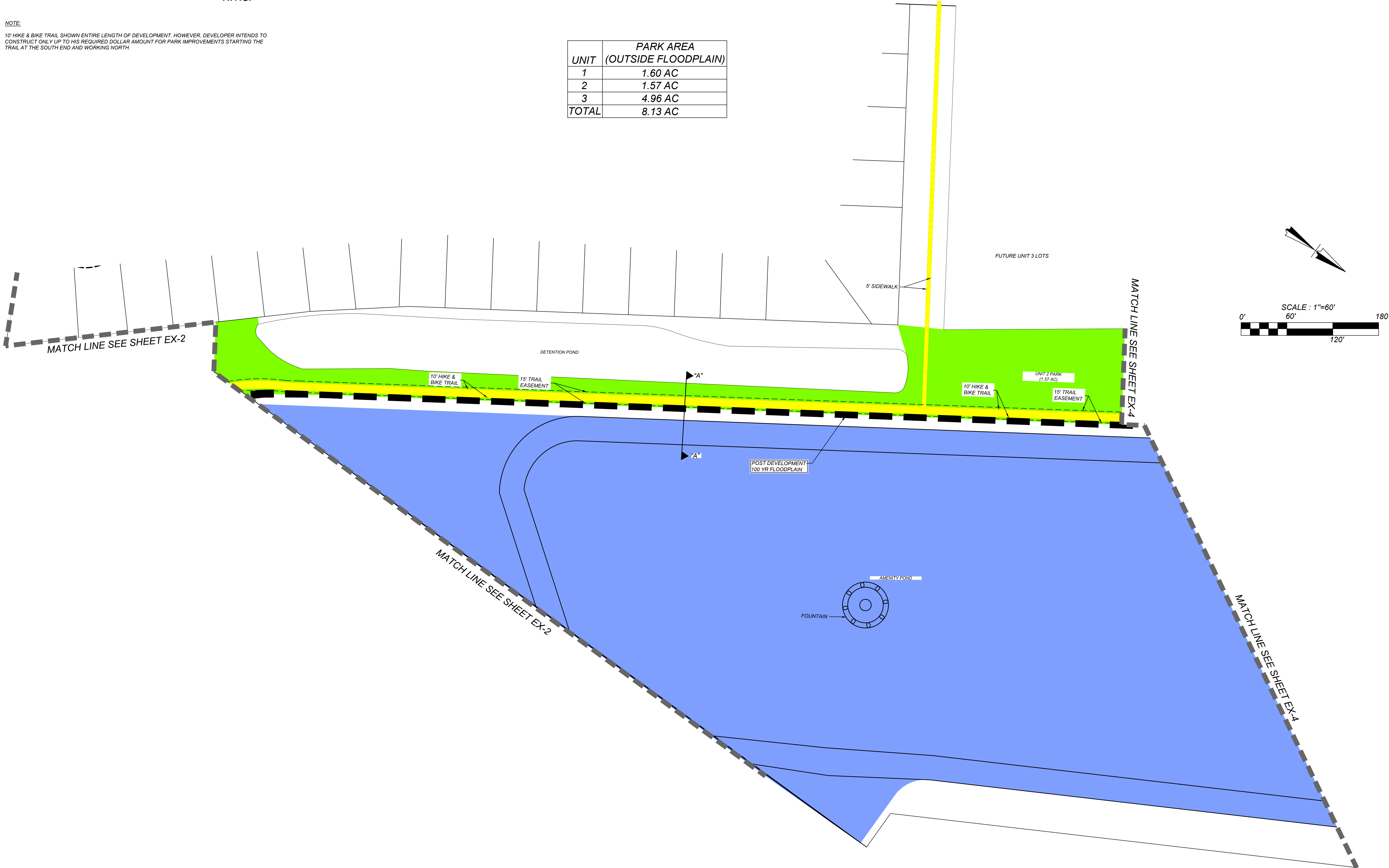

ISSUE/DATE

REVISIONS

MEADOWS OF MILL CREEK UNIT 2
SEGUN, TEXAS
PARK PLAN

Date: Jul 25, 2022, 11:36am User ID: nscggo
File: U:\Projects\805\01\01\Design\Exhibits\CAD\Park Plan Unit 3.dwg

MATCH LINE SEE SHEET EX-3

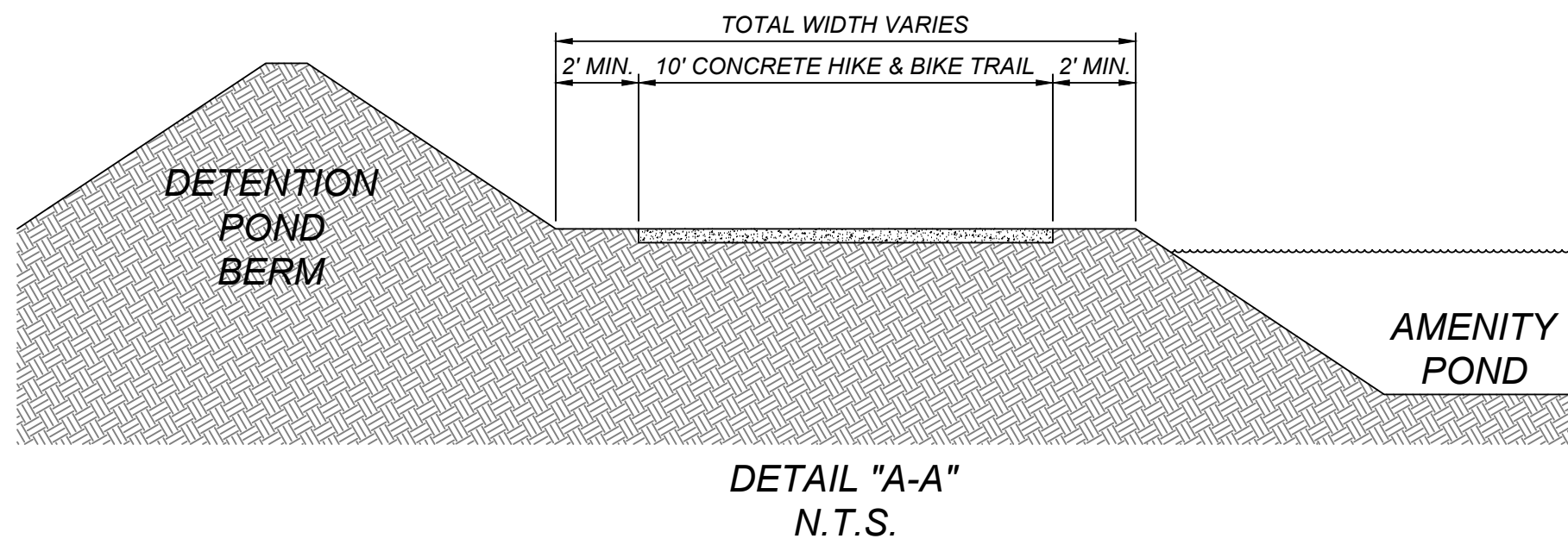

NOTE:
10' HIKE & BIKE TRAIL SHOWN ENTIRE LENGTH OF DEVELOPMENT, HOWEVER, DEVELOPER INTENDS TO CONSTRUCT ONLY UP TO HIS REQUIRED DOLLAR AMOUNT FOR PARK IMPROVEMENTS STARTING THE TRAIL AT THE SOUTH END AND WORKING NORTH.

UNIT	PARK AREA (OUTSIDE FLOODPLAIN)
1	1.60 AC
2	1.57 AC
3	4.96 AC
TOTAL	8.13 AC

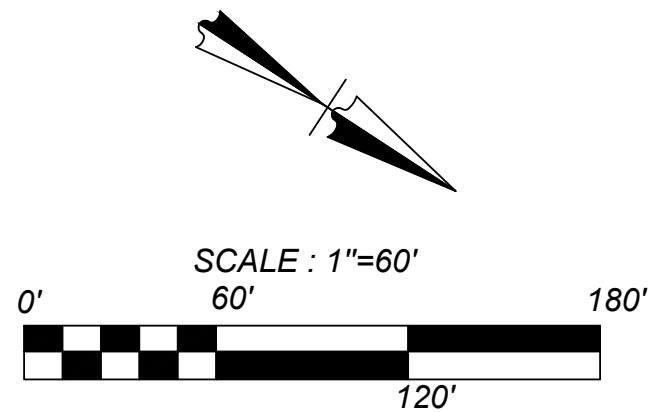
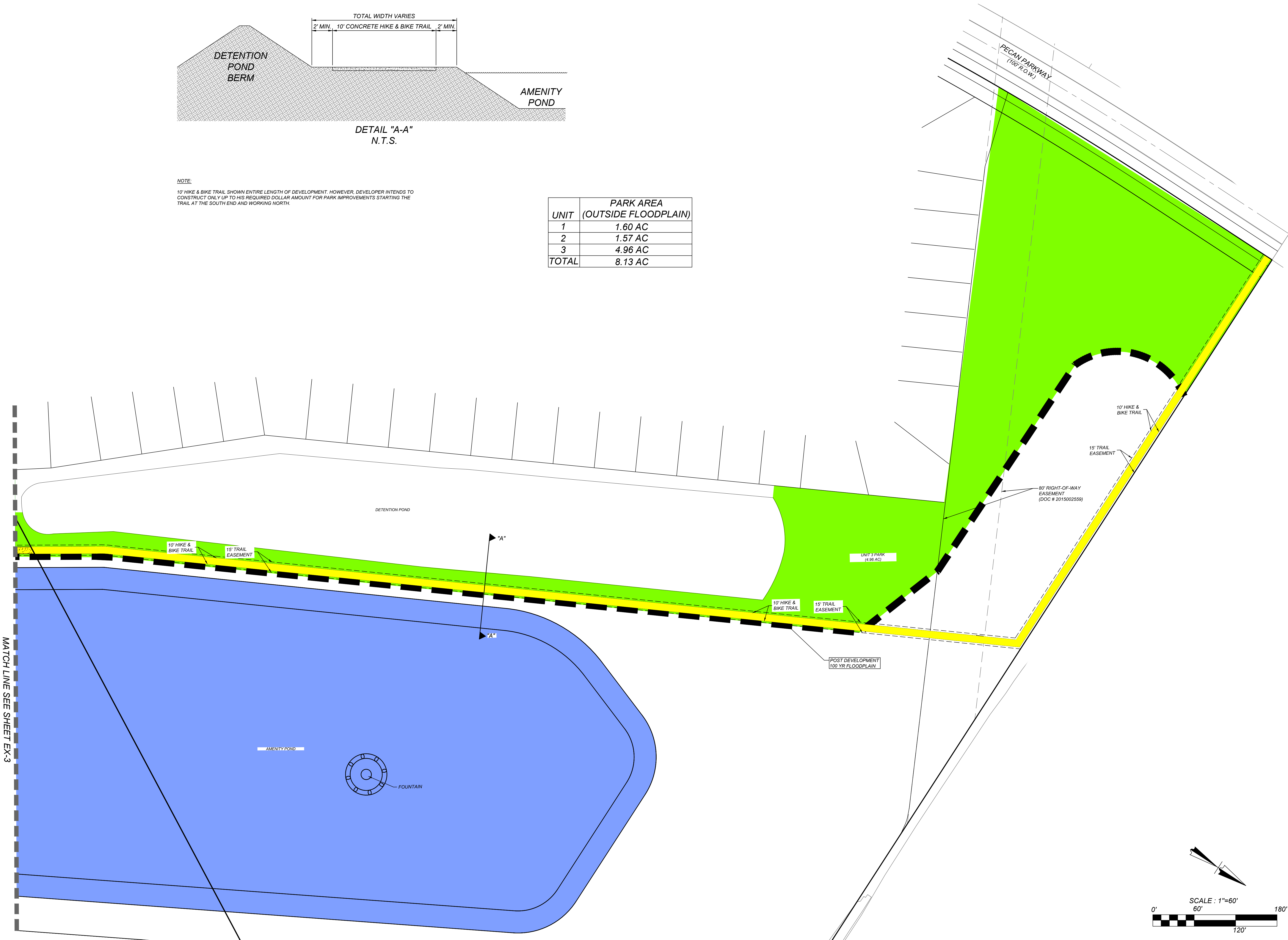

MEADOWS OF MILL CREEK UNIT 3
SEGUIN, TEXAS
PARK PLAN

JOB NO. 805-01-01
DATE: July 2022
DRAWN: RMRD CHECKED: WF
SHEET NUMBER:
EX-4

KFW
ENGINEERS + SURVEYING
P.O. Box 18307, Dallas, TX 75218
Phone: (800) 224-6422 Fax: (800) 627-6897
TBPE Firm #: 9513 • TBPLS Firm #: 1022300

ISSUE DATE

REVISIONS