

Bauer Park
Seguin, TX 78156

Play & Park Structures

This play equipment is recommended for children ages:
5-12 & 13&UP
Minimum Area Required:
Per Site

Scale: 1" = 20'-0"
This drawing can be scaled only when in an 24" x 36" format

Drawn By:
Kimber Scroggins
Date:
10/19/2022
Quote Number:
803-154626A

play&park structures
A PLAYCORE Company

544 Chestnut Street
Chattanooga, TN 37402
800-727-1907 / www.playandpark.com

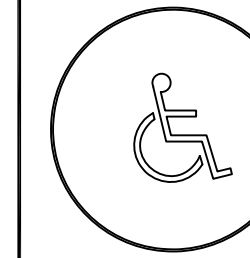

Total Play Components	41		
Elevated Play Components	22		
Elevated Play Components Accessible by Ramp	12	Req.	11
Elevated Components Accessible by Transfer	21	Req.	11
Accessible Ground Level Components Shown	19	Req.	0
Different Types of Ground Level Components	7	Req.	0

User Capacity
125-150
Critical Fall Height
8'-0"

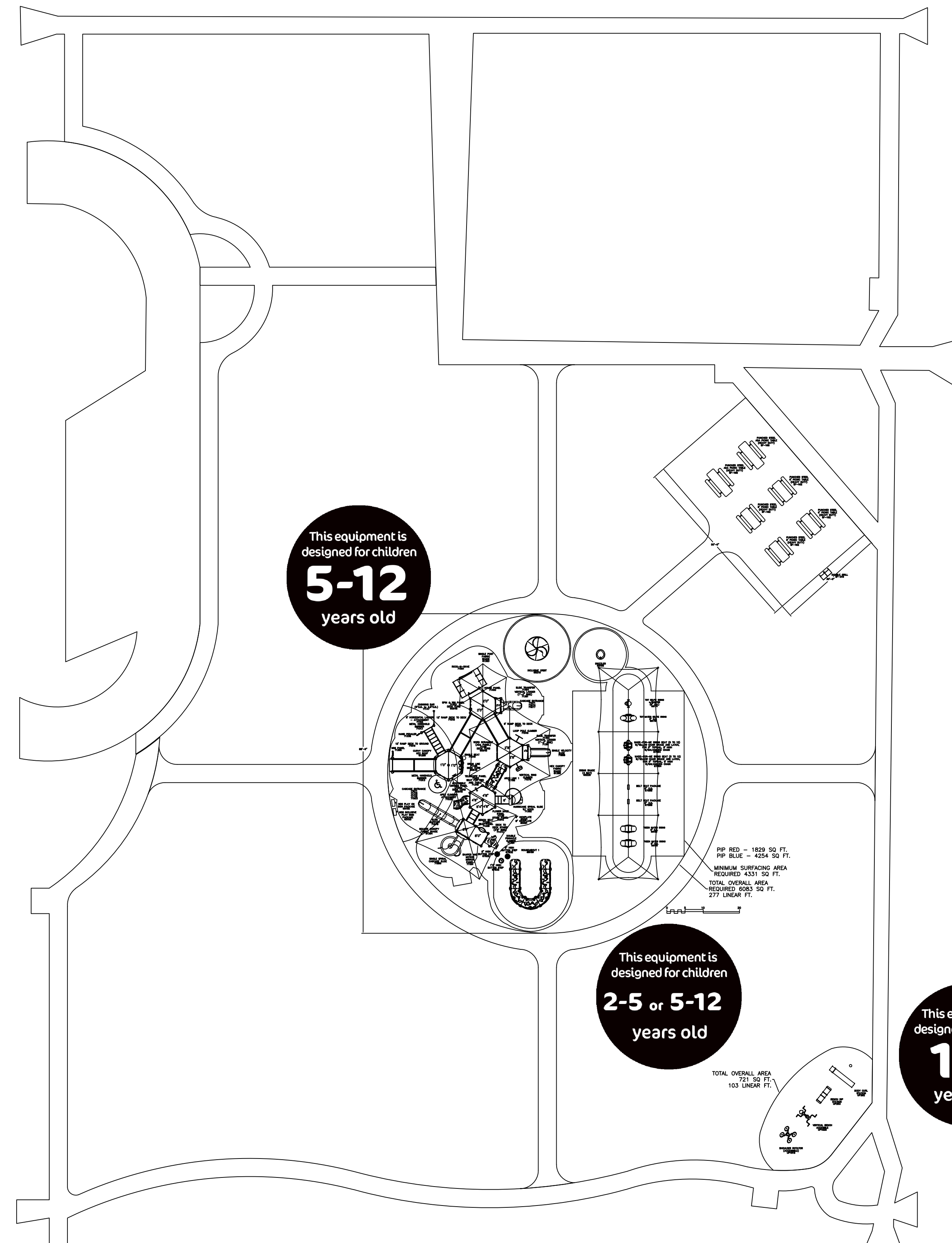

It is the manufacturer's opinion that the structure shown herein complies with current ada standards concerning accessibility if used with proper accessible surfacing and together with other necessary ground level play equipment.
Top View drawings and measurements are for overall site and structure appearance purposes. Top view should not be conceived as a construction detail; therefore, all measurements and slope requirements should be field verified prior to construction.
IMPORTANT: Never install play equipment over hard, unresilient surfaces such as asphalt, concrete, or compacted earth. It is the owner's responsibility to ensure the "minimum area required" contains an appropriate amount of resilient material to cushion accidental falls.